



*"Setting the World's
Performance Standards!"*

743 E. Iona Rd. Idaho Falls, ID 83401, (208)529-0244 Fax (208)529-9000

SLP Angled Foot Rests for 2008-10 Ski-Doo XP Part #32-594

Parts List

1 - Foot Rest Right (#32-594R)	1 - Foot Rest Left (#32-594L)
4 - 1/4" 20 Nylock Nuts (#999-0032)	4 - 1/4" 20 x 3/4" Bolt (#999-5040)
8 - 1/4" Flat Washers (#999-0010)	4 - 3/16" Aluminum Rivets (#999-0132)

Installation Instructions

1. To distinguish between left and right foot rests the top angled corner goes toward the outside of sled.
2. Place top front of the foot rest into the stock footwell and align holes with the top slotted holes in the foot well. Loosely bolt into place using provided 1/4" bolts and flat washers (see Illustration #1).
3. With the foot rest loosely in place align the rear outside corner so it is up to but not over the rolled tunnel edge (see Illustration #2). Some of the stock tunnel grips will need to be bent flat for the foot rest to sit flush on the foot well (use a hammer and punch or channel lock pliers to do so).
4. Using the foot rest as a guide, drill the two holes through the tunnel and steel backing plate. Rivet into place with the provided rivets and tighten front bolts.
5. Repeat on the other side.

Illustration #1

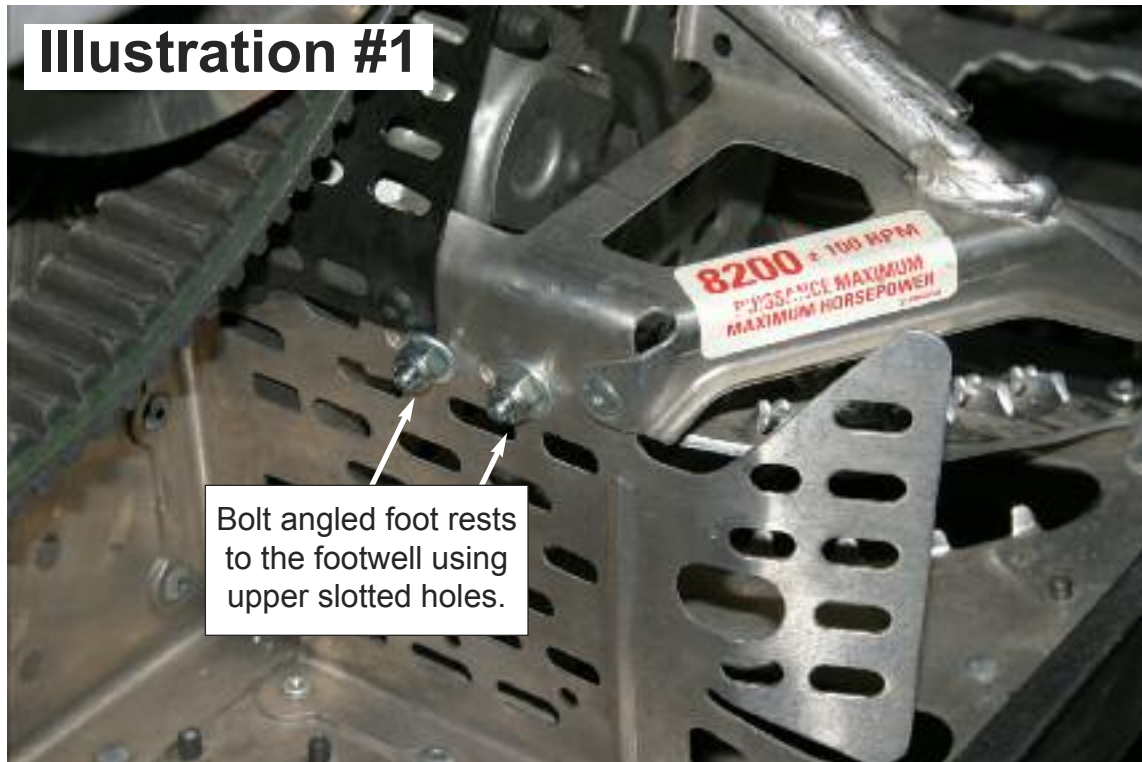

Illustration #2

